

The Barn at Moody Mountain Farm  
Physical address: 100 Pork Hill Road  
Wolfeboro, New Hampshire  
Catering and Bartending Services Policies

We rent our barn as a venue only. Your client is responsible for securing and coordination of all rentals required for their reception (tables, chairs, linens, plate ware, flatware and glassware, flowers, etc.). **There are no kitchen facilities on site.**

Certificate of Insurance

You must supply us proof of general business liability insurance prior to catering at The Barn at Moody Mountain Farm. If you are a bartending service, please supply proof of your liquor liability insurance. Please email to: moodymtfarm@gmail.com at least two weeks prior to the event. Please also include any pertinent information about the event including your contact information for the day of the event.

Cooking

No open-flame cooking of any kind is allowed in the barn. Sterno may be used for chafing dishes during the event under the supervision of your staff. Only LED candles may be used for table decorations. No live open-flame candles allowed.

Set Up Area

The catering set up area is in the rear of the barn. Please see page 2 for a scale drawing of the barn. Many caterers in the past have set their staging area up outside under a tent. Please inform your client if this will be necessary as either they or you will need to acquire the tent. In the event a tent used by wedding guests is set up next to the barn, you may have to set your staging area below the barn.

Barn Access

Access to the barn for the purposes of unloading and set up is either from the driveway, or by driving around the back mountain side of the barn and unloading near the catering staging area door (see bird's eye Google Earth layout on page 3). **Under no circumstances should any vehicle gain access to the barn through the field between the road and the barn or between the barn and the stonewall.**

Water and Electrical

There are ample electrical outlets accessible with the use of extension cords which you must supply. There is potable water (cold water only) at the pump house with ample lengths of hose available for your use. Please rinse dishes off in the wooded area behind the pump house. Leftover food debris should be collected and discarded.

Clean-up/Garbage Removal

It is the caterer's responsibility to remove all food-related trash the day/evening of the event. Any remaining trash/recyclables must be separated per Wolfeboro Recycling Rules and placed in the bins provided. Please don't throw cocktail straws, lemons/limes on the lawns to discard them---they take a long time to biodegrade.

Parking

After unloading, please park on the street (barn side). Please do not park your vehicles on the lawn.

Contact Information

For questions prior to the day of the event, please email us at moodymtfarm@gmail.com or call us at (603) 498-2618. We will be around prior to the event to make sure you and the client are set. For logistical questions and concerns the day of the event, please contact us at the following numbers in the order listed: (603) 498-2618; (603) 498-2888.

**\*\*NOTE\*\*** On occasion, our barn assistant Josh Arnold fills in for us, in which case he will be the one to stop by to check in. To reach Josh Arnold the day of the event please call (603) 539-6460 or (603) 344-5009.

# The Barn at Moody Mountain Farm Floor Plan

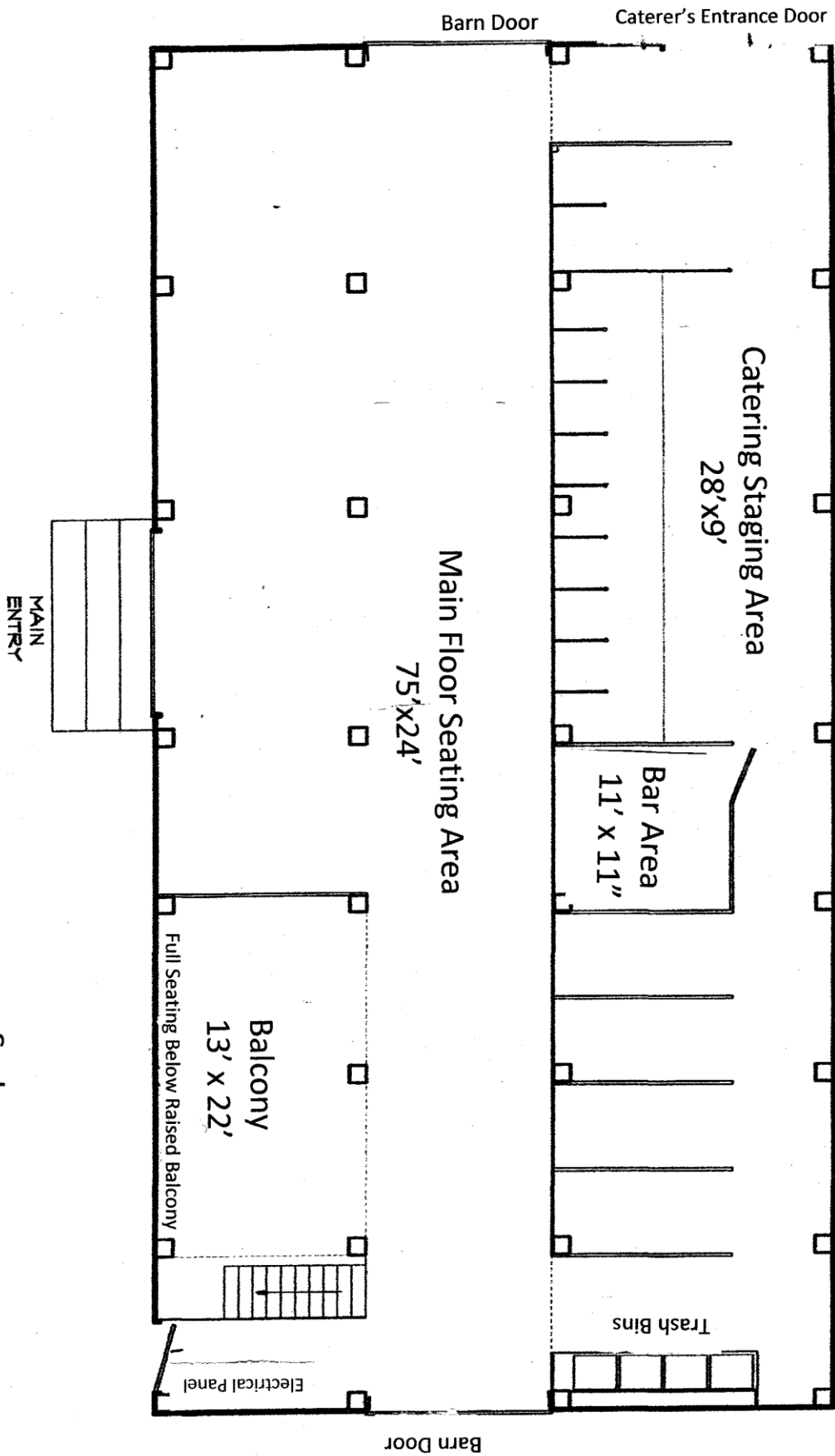

Scale

1" = 8.85' (approximate)

10/9/2014



Moody Mountain Farm

- 1 - House
- 2 - Catering Access
- 3 - Big Hay Field
- 4 - Barn
  - 4A - 26ft
  - 4B - 45ft
  - 4C - 60ft
  - 4D - 40ft
- 5 - Restrooms
- 6 - Pump House
- 7 - Sunken Garden
  - 7A - 62ft
  - 7B - 49ft
- 8 - Wood Shed